

MS-7TPH4233PA-F

Explosion-Proof Bispectral + IR PTZ Camera



Key Features

- Uncooled VOx Micro bolometer with 400×300 resolution
- 15/35/50 mm fixed lens optional, 30x optical zoom
- Sensitivity $\leq 40\text{mK}$
- Support temperature monitoring exception alarm
- Support 3 temperature measurement rule types (point, line, polygon)
- Support human and vehicle detection
- Intelligent analysis: intrusion, single line crossing, double line crossing, loitering, wrong-way, people counting, enter area, leave area
- 17 color control
- IP68

Specification

Thermal Camera			
Detector Type	Uncooled VOx Micro bolometer 400×300		
Resolution	Sensor is 400×300. Image can be scaled up to 704×576		
Pixel size	17μm		
Spectral Range	8-14μm		
Thermal Sensitivity (NETD)	≤ 40 mK		
Lens Type	Fixed		
Focus Control	Manual Focus		
Focal Length	15 mm	35 mm	50 mm
F No.	F1.0	F1.0	F1.0
Angle of View	H:25.5°, V:19.2°	H: 11°, V:9°	H: 7.7°, V:5.8°
Detection Distance Fire(1*1m)	441 m	1029 m	1471 m
Detection Distance Man(1.8*0.5m)	441 m	1029 m	1471 m
Detection Distance Vehicle(4*1.5m)	1353 m	3137 m	4510 m
Recognition Distance Man(1.8*0.5m)	110 m	257 m	368 m
Recognition Distance Vehicle(4*1.5m)	338 m	789 m	1127 m
Visible Camera			
Image Sensor	1/2.8" Sony CMOS		
Max. Resolution	2592 (H)×1944 (V)		
Shutter Speed	1/1 ~ 1/30,000s		
Min. Illumination	Color: 0.07 Lux @ (F1.6, AGC ON), B/W: 0.02 Lux, 0 Lux with IR on		
S/N Ratio	More than 55 dB		
Focal Length	5.3 ~ 159mm		
Max Aperture	F1.6 ~ F4.3		
Angle of View	H: 55° ~ 2.3°, V: 41.6° ~ 1.7°		
Optical Zoom	30x		
Focus Control	Auto/Manual/Semi-automatic		
Mirror	Support		
Defog	Support		
Privacy Masking	Support		
Illumination Distance	IR distance up to 100m (328.08 ft)		
PTZ			
Pan/Tilt Range	Pan: 0° ~ 360° endless, Tilt: +90° ~ -90°		
Pan/Tilt Speed	Pan: 0.1° ~ 30°/s, Tilt: 0.1° ~ 20°/s		
Wiper	Support		
Preset Accuracy	± 0.2°		
Presets	400		
Scan	8 scans, up to 32 presets per scan		
Patrol	12 patrols, up to 32 presets per scan		
Track	6 tracks		
3D Positioning	Support		
Speed Setup	Auto/Manual (0-8)		
Power Off Memory	Support		
Idle Motion	It can activate Preset/ Scan/Tour/Pattern if there is no command in the specified period		

Video and Audio	
Main Stream	Visible: 2592×1944, 2592×1520, 1920×1080, 1280×720 @25/30fps Thermal: D1 @25/30fps
Sub Stream	Visible: D1, VGA, CIF @25/30fps Thermal: CIF @25/30fps
Bit Rate Control	CBR/VBR
Bit Rate	Visible: main stream: 200Kbps ~ 12Mbps, sub stream: 100Kbps ~ 6Mbps Thermal: main stream: 100Kbps ~ 6Mbps, sub stream: 10Kbps ~ 1.5Mbps
Region of Interest	Off / On (8 Zone, Rectangle)
Smart Encode	Support
Audio Compression	G.711: 8kbps, RAW_PCM: 16kbps
Temperature Detection	
Temperature Detection	Support 3 temperature measurement rule types (point, line, polygon)
Temperature Alarm	Temperature difference alarm, Threshold alarm, Temperature rise alarm
Accuracy	±2°C (35.6°F) / ±2%
Response Time	≤ 30ms
Temperature Range	-20°C ~ 150°C (-4°F ~ 302°F)
Smart Function	
Smart Alarm	Motion detection, I/O alarm, Disk alarm, IVS alarm, Temperature detection & alarm
Intelligent Functions	Temperature detection & alarm, Human detection, Vehicle detection
Intelligent Analysis	Intrusion, Single line crossing, Double line crossing, Loitering, Wrong way, Enter area, Leave area Support alarm triggering by specified target types (human and vehicle), People counting
Network	
Protocols	IPv4/IPv6, HTTP, RTSP/RTP/RTCP, TCP/UDP, DHCP, DNS, PPPOE, SMTP, 802.1x
Interoperability	ONVIF, CGI, SDK
Web Viewer	<IE11, Chrome, Firefox, Microsoft Edge
Web Language	English, Chinese, Polish, Italian, Portuguese, Spanish, Russian, French, Czech, Hungarian
Interface	
Network Interface	1 Ethernet (10/100 Base-T) RJ-45 Connector
Audio Interface	1ch input, 1ch output
Alarm Interface	5ch input, 1ch output
CVBS Interface	1ch (Visible)
RS485	Support
Reset Button	Built-in
SD Card Slot	Built-in Micro SD card slot, up to 256GB
General	
Power Supply	100 ~ 240 VAC
Power Consumption	Max 75 W
Working Temperature	-40°C ~ 60°C (-40°F ~ 140°F)
Storage Conditions	0~ 90% RH
Certifications	CE/FCC
Ingress Protection	IP68
Casing	SUS316L
Dimensions	530 × 350 × 395mm (20.87 × 13.78 × 15.55 inch)
Net Weight	52 kg (114.64 lb)

Accessories

Optional:

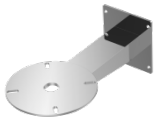

MS-7BK402-SS
Wall Mount



MS-7BK400-SS(P/F/D)
Junction Box



MS-7CPL10A-SS
Washing Tank



Flexible Tube